

HLJB/HFJBF Type

Swivel Bracket with Stopper for Pneumatic Rubber / Airless Wheel

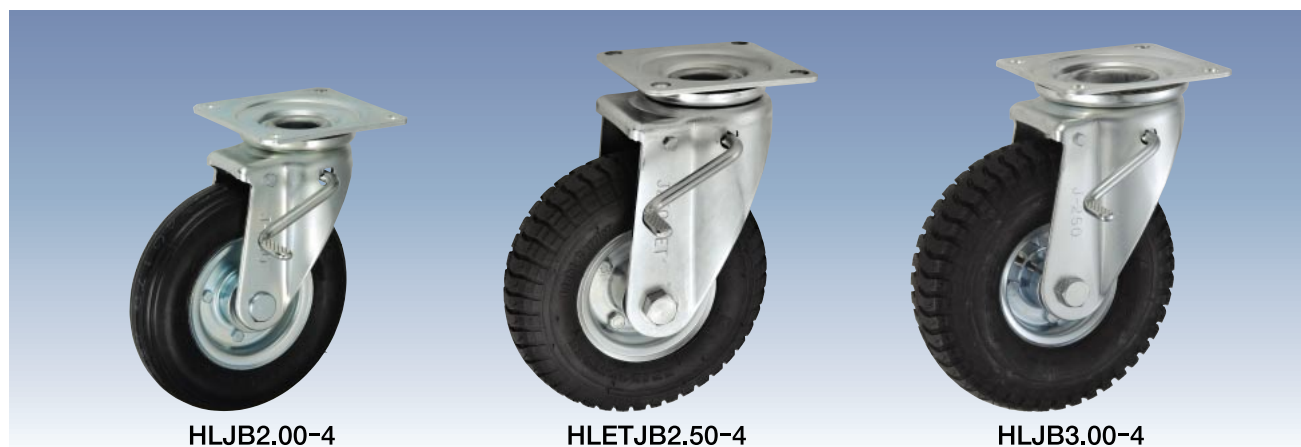



HLJB2.00-4

HLETJB2.50-4

HLJB3.00-4

Unit: mm

Model Number	Wheel	Bearing	Load Capacity		Tire		Standard Air Pressure (kgf/cm ²)	Shaft Diameter D	Overall Height H1	Plate Size F1/F2	Mounting Hole Spacing P1/P2	Plate Hole d	Offset E	Weight (g)		
					Diameter A	Width R										
																
			(daN)	(kgf)												
HLJB2.00-4	BLACK	B/B	80	81.6	210	50	2.5	20	260	140/140	112/112	11	58	3,690		
	GRAY	B/B												3,690		
HFJBF6 $\frac{1}{2}$ ×2-4	BLACK	B/B	80	81.6	169	50	2.5	20	234	140/140	112/112	14	58	4,340		
	GRAY	B/B												4,340		
HLETJB2.50-4	BS	B/B	85	86.7	225	65	3.5	20	292	140/140	112/112	14	58	4,780		
	FO	B/B			218	62			289					4,690		
	AL	B/B	100	102.0	220	60	—	290	5,910							
HLJB3.00-4	BS	B/B	110	112.2	253	82	3.5	20	306	160/160	125/125	14	71	5,480		
	FO	B/B			250	76			305					5,370		
	AL	B/B	130	132.6	248	73	—	304	7,500							

Bearing: B/B -- Steel bearing

Wheel: BLACK -- Tire Color : BLACK
 GRAY -- Tire Color : GRAY
 PU -- PU Type Airless Tire (Foaming Urethane)
 BS -- Tire Made by Bridgestone
 FO -- Tire Made by an Overseas Maker
 AL -- Airless / Solid Tire

The outer diameter and width of a tire were measured at the standard air pressure under the unloaded condition. They may vary according to usage conditions.

[Bracket Dimensions]

Unit: mm

Model Number	Bracket Height H	Bracket Width B	Weight (g)
JB2.00-4	155	56	2,580
JB6 $\frac{1}{2}$ ×2-4	150	90	3,070
JB2.50-4ET	180	90	3,230
JB3.00-4	180	90	3,660

* The shaft set is included in the bracket.

[Pedal Dimensions]

Unit: mm

Model Number	Pedal Rod K	Radius of Gyration S
JB2.00-4	120	148
JB6 $\frac{1}{2}$ ×2-4	130	156
JB2.50-4ET	130	156
JB3.00-4	135	160

The JB Type bracket can lock or unlock the wheel and frame at the same time just by stepping the pedal. This was designed under the assumption that it is combined with the pneumatic rubber / airless wheel produced by our company. If this is combined with a tire whose outer diameter is not within the range below, the tire may slip or the tire may interfere with the stopper mechanism. Use the tire with the specified air pressure.

Unit: mm

Compatible Tire Diameter (Rough Standard)
210~206
169~166
225~216
253~248

