



PJA-75

PNAJA-75

Size 	Model Number	Wheel	Bearing	Load Capacity		Tire Width R	Shaft Diameter D	Overall Height H1	Plate Size F1/F2	Mounting Hole Spacing P1/P2	Plate Hole d	Offset E	Weight (g)
				 (daN)	(kgf)								
75	■ Nylon												
	PJA-75	Nylon		100	102.0	32	10	101	82/82	63/63	9.5	22	420
	PBJA-75	Nylon	B/B	120	122.4								480
	PBDJA-75	Nylon	SUS										480
	■ Nylon Rim · Rubber Wheel												
	PNJA-75	Rubber	B/B	70	71.4	32	10	101	82/82	63/63	9.5	22	510
	PNDJA-75	Rubber	SUS										510
	PNAJA-75	Rubber											470
	■ Nylon Rim · Urethane Rubber Wheel												
	PNUJA-75	Urethane	B/B	100	102.0	32	10	101	82/82	63/63	9.5	22	500
	PNUDJA-75	Urethane	SUS										500
	PNUAJA-75	Urethane											450
	■ Monomer Cast Nylon												
	UWBJA-75	MC Nylon	B/B	150	153.0	24	10	101	82/82	63/63	9.5	22	520
	UWBDJA-75	MC Nylon	SUS										520
	UWAJA-75	MC Nylon											480
	UWBSJA-75	MC Nylon	B/B										500
	UWBSDJA-75	MC Nylon	SUS										500
	■ Steel Rim · Rubber Wheel <b>Wheel rim is not stainless steel.</b>												
	SJA-75	Rubber	B/B	80	81.6	32	10	101	82/82	63/63	9.5	22	530
	SRJA-75	Red Rubber	B/B	60	61.2								530
CRJA-75	Heat-resistance	B/B	80	81.6	550								
■ Steel Rim · Urethane Rubber Wheel <b>Wheel rim is not stainless steel.</b>													
SUIJA-75	Urethane	B/B	120	122.4	32	10	101	82/82	63/63	9.5	22	610	
SUIEJA-75	Anti-Static	B/B										610	

Unit: mm

Bearing: No mark -- Spindle sleeve, B/B -- Steel bearing, SUS -- Stainless steel bearing

 Build-to-order manufacturing

● The materials of JA Type bracket are all stainless steel (SUS 304 / 18-8 stainless).

# JA Type

Size: 100mm

Stainless Steel Swivel Bracket



PJA-100



PNAJA-100

Stainless Steel Caster Series

Unit: mm

Size 	Model Number	Wheel	Bearing	Load Capacity		Tire Width R	Shaft Diameter D	Overall Height H1	Plate Size F1/F2	Mounting Hole Spacing P1/P2	Plate Hole d	Offset E	Weight (g)	
				(daN)	(kgf)									
100	■ Nylon													
	PJA-100	Nylon		120	122.4									870
	PBJA-100	Nylon	B/B	180	183.6	35	12	144	95/95	71/71	11	35	930	
	PBDJA-100	Nylon	SUS										930	
	■ Nylon Rim · Rubber Wheel													
	PNJA-100	Rubber	B/B											970
	PNDJA-100	Rubber	SUS	100	102.0	32	12	144	95/95	71/71	11	35	970	
	PNAJA-100	Rubber												910
	■ Nylon Rim · Urethane Rubber Wheel													
	PNUJA-100	Urethane	B/B	150	153.0	32	12	144	95/95	71/71	11	35	950	
	PNUDJA-100	Urethane	SUS											950
	PNUAJA-100	Urethane		100	102.0									890
	■ Monomer Cast Nylon													
	UWBJA-100	MC Nylon	B/B											1,080
	UWBDA-100	MC Nylon	SUS			29								1,080
	UWAJA-100	MC Nylon		200	204.0		12	144	95/95	71/71	11	35	1,030	
	UWBSJA-100	MC Nylon	B/B											1,030
	UWBSDJA-100	MC Nylon	SUS			30								1,030
	■ Steel Rim · Rubber Wheel <span style="color: blue;">Wheel rim is not stainless steel.</span>													
	SJA-100	Rubber	B/B	130	132.6									1,070
SRJA-100	Red Rubber	B/B	100	102.0	35	12	144	95/95	71/71	11	35	1,070		
CRJA-100	Heat-resistance	B/B	130	132.6									1,100	
■ Steel Rim · Urethane Rubber Wheel <span style="color: blue;">Wheel rim is not stainless steel.</span>														
SUIJA-100	Urethane	B/B											1,140	
SUIEJA-100	Anti-Static	B/B	180	183.6	32	12	144	95/95	71/71	11	35	1,140		

Bearing: No mark -- Spindle sleeve, B/B -- Steel bearing, SUS -- Stainless steel bearing

Build-to-order manufacturing

● The materials of JA Type bracket are all stainless steel (SUS 304 / 18-8 stainless).

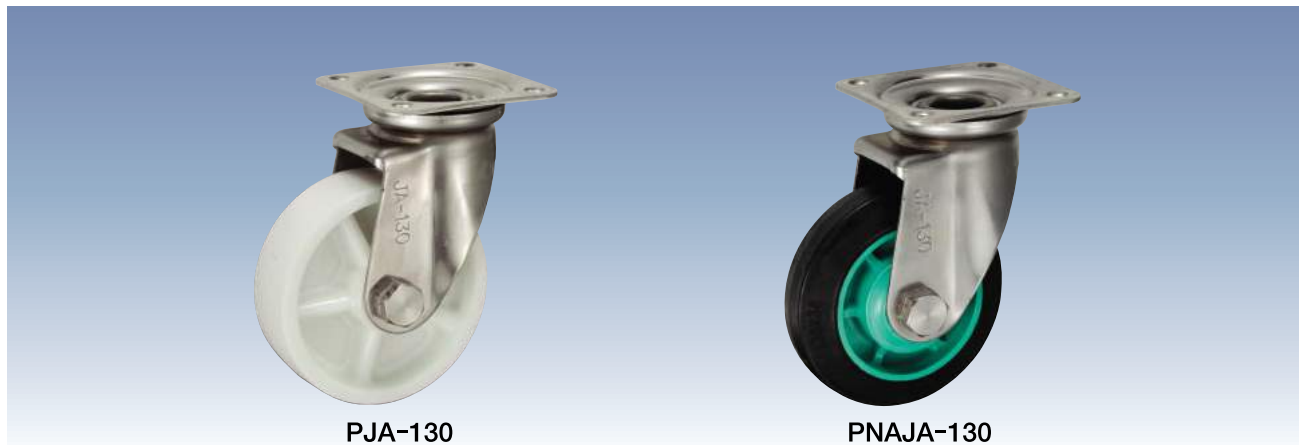

PJA-130

PNAJA-130

Size 	Model Number	Wheel	Bearing	Load Capacity		Tire Width R	Shaft Diameter D	Overall Height H1	Plate Size F1/F2	Mounting Hole Spacing P1/P2	Plate Hole d	Offset E	Weight (g)	
				(daN)	(kgf)									
130	■ Nylon													
	PJA-130	Nylon		150	153.0	42	20	177	108/108	80/80	11	40	1,400	
	PBJA-130	Nylon	B/B	250	255.0								1,600	
	PBDJA-130	Nylon	SUS										1,600	
	■ Nylon Rim · Rubber Wheel													
	PNJA-130	Rubber	B/B	145	147.9	38	20	177	108/108	80/80	11	40	1,660	
	PNDJA-130	Rubber	SUS										1,660	
	PNAJA-130	Rubber											120	122.4
	■ Nylon Rim · Urethane Rubber Wheel													
	PNUJA-130	Urethane	B/B	200	204.0	35	20	177	108/108	80/80	11	40	1,600	
	PNUDJA-130	Urethane	SUS										1,600	
	PNUAJA-130	Urethane											120	122.4
	■ Monomer Cast Nylon													
	UWBJA-130	MC Nylon	B/B	300	306.0	36	20	177	108/108	80/80	11	40	1,880	
	UWBDA-130	MC Nylon	SUS										1,880	
	UWAJA-130	MC Nylon											1,730	
	UWBSJA-130	MC Nylon	B/B			30							1,620	
	UWBSDJA-130	MC Nylon	SUS										1,620	
	■ Steel Rim · Rubber Wheel <b>Wheel rim is not stainless steel.</b>													
	SJA-130	Rubber	B/B	180	183.6	42	20	177	108/108	80/80	11	40	1,860	
SRJA-130	Red Rubber	B/B	140	142.8	1,860									
CRJA-130	Heat-resistance	B/B	180	183.6	1,890									
■ Steel Rim · Urethane Rubber Wheel <b>Wheel rim is not stainless steel.</b>														
SUIJA-130	Urethane	B/B	250	255.0	35	20	177	108/108	80/80	11	40	1,990		
SUIEJA-130	Anti-Static	B/B										1,990		

Unit: mm

Bearing: No mark -- Spindle sleeve, B/B -- Steel bearing, SUS -- Stainless steel bearing

 Build-to-order manufacturing

● The materials of JA Type bracket are all stainless steel (SUS 304 / 18-8 stainless).

# JA Type

Size: 150mm

Stainless Steel Swivel Bracket



PJA-150



PNAJA-150

Stainless Steel Caster Series

Unit: mm

Size 	Model Number	Wheel	Bearing	Load Capacity		Tire Width R	Shaft Diameter D	Overall Height H1	Plate Size F1/F2	Mounting Hole Spacing P1/P2	Plate Hole d	Offset E	Weight (g)	
				(daN)	(kgf)									
150	<b>■Nylon</b>													
	PJA-150	Nylon		180	183.6									1,880
	PBJA-150	Nylon	B/B	300	306.0	45	20	198	120/120	90/90	11	45	2,120	
	PBDJA-150	Nylon	SUS										2,120	
	<b>■Nylon Rim · Rubber Wheel</b>													
	PNJA-150	Rubber	B/B											2,140
	PNDJA-150	Rubber	SUS			38	20	198	120/120	90/90	11	45	2,140	
	PNAJA-150	Rubber				140	142.8							1,980
	<b>■Nylon Rim · Urethane Rubber Wheel</b>													
	PNUJA-150	Urethane	B/B											2,100
	PNUDJA-150	Urethane	SUS		250	255.0	38	20	198	120/120	90/90	11	45	2,100
	PNUAJA-150	Urethane			150	153.0								1,910
	<b>■Monomer Cast Nylon</b>													
	UWBJA-150	MC Nylon	B/B											2,560
	UWBDA-150	MC Nylon	SUS				40							2,560
	UWAJA-150	MC Nylon			350	357.0		20	198	120/120	90/90	11	45	2,410
	UWBSJA-150	MC Nylon	B/B				30							2,160
	UWBSDJA-150	MC Nylon	SUS											2,160
	<b>■Steel Rim · Rubber Wheel</b> <span style="color: blue;">Wheel rim is not stainless steel.</span>													
	SJA-150	Rubber	B/B		200	204.0								2,430
	SRJA-150	Red Rubber	B/B		160	163.2	45	20	198	120/120	90/90	11	45	2,430
CRJA-150	Heat-resistance	B/B		200	204.0								2,470	
<b>■Steel Rim · Urethane Rubber Wheel</b> <span style="color: blue;">Wheel rim is not stainless steel.</span>														
SUIJA-150	Urethane	B/B											2,620	
SUIEJA-150	Anti-Static	B/B		300	306.0	38	20	198	120/120	90/90	11	45	2,620	









Bearing: No mark -- Spindle sleeve, B/B -- Steel bearing, SUS -- Stainless steel bearing

Build-to-order manufacturing

●The materials of JA Type bracket are all stainless steel (SUS 304 / 18-8 stainless).

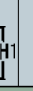

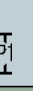
Unit: mm

Size 	Model Number	Wheel	Bearing	Load Capacity		Tire Width R 	Shaft Diameter D 	Overall Height H1 	Plate Size F1/F2 	Mounting Hole Spacing P1/P2 	Plate Hole d 	Offset E 	Weight (g) 
				(daN)	(kgf)								
200	<b>■Nylon</b>												
	PJA-200	Nylon		250	255.0	45	20	250	140/140	112/112	11	58	2,910
	PBJA-200	Nylon	B/B	400	408.0								3,120
	PBDJA-200	Nylon	SUS	400	408.0								3,120
	<b>■Nylon Rim·Rubber Wheel</b>												
	PNJA-200	Rubber	B/B	220	224.4	42	20	250	140/140	112/112	11	58	3,190
	PNDJA-200	Rubber	SUS										3,190
	PNAJA-200	Rubber											160
	<b>■Nylon Rim·Urethane Rubber Wheel</b>												
	PNUJA-200	Urethane	B/B	350	357.0	42	20	250	140/140	112/112	11	58	3,060
	PNUDJA-200	Urethane	SUS										3,060
	PNUAJA-200	Urethane											250
	<b>■Monomer Cast Nylon</b>												
	UWBJA-200	MC Nylon	B/B	500	510.0	42	20	250	140/140	112/112	11	58	4,070
	UWBDA-200	MC Nylon	SUS										4,070
	UWAJA-200	MC Nylon											3,920
	UWBSJA-200	MC Nylon	B/B										3,530
	UWBSDJA-200	MC Nylon	SUS			34	3,530						
	<b>■Steel Rim·Rubber Wheel</b> <i>Wheel rim is not stainless steel.</i>												
	SJA-200	Rubber	B/B	250	255.0	45	20	250	140/140	112/112	11	58	3,840
	SRJA-200	Red Rubber	B/B	200	204.0								3,840
	SHJA-200	High-Rebound	B/B	250	255.0								3,840
CRJA-200	Heat-resistance	B/B	250	255.0	3,920								
<b>■Steel Rim·Urethane Rubber Wheel</b> <i>Wheel rim is not stainless steel.</i>													
SUIJA-200	Urethane	B/B	400	408.0	42	20	250	140/140	112/112	11	58	4,010	
SUIEJA-200	Anti-Static	B/B										4,010	

Bearing: No mark -- Spindle sleeve, B/B -- Steel bearing, SUS -- Stainless steel bearing

 Build-to-order manufacturing

●The materials of JA Type bracket are all stainless steel (SUS 304 / 18-8 stainless).

# JA Type

Stainless Steel Swivel Bracket

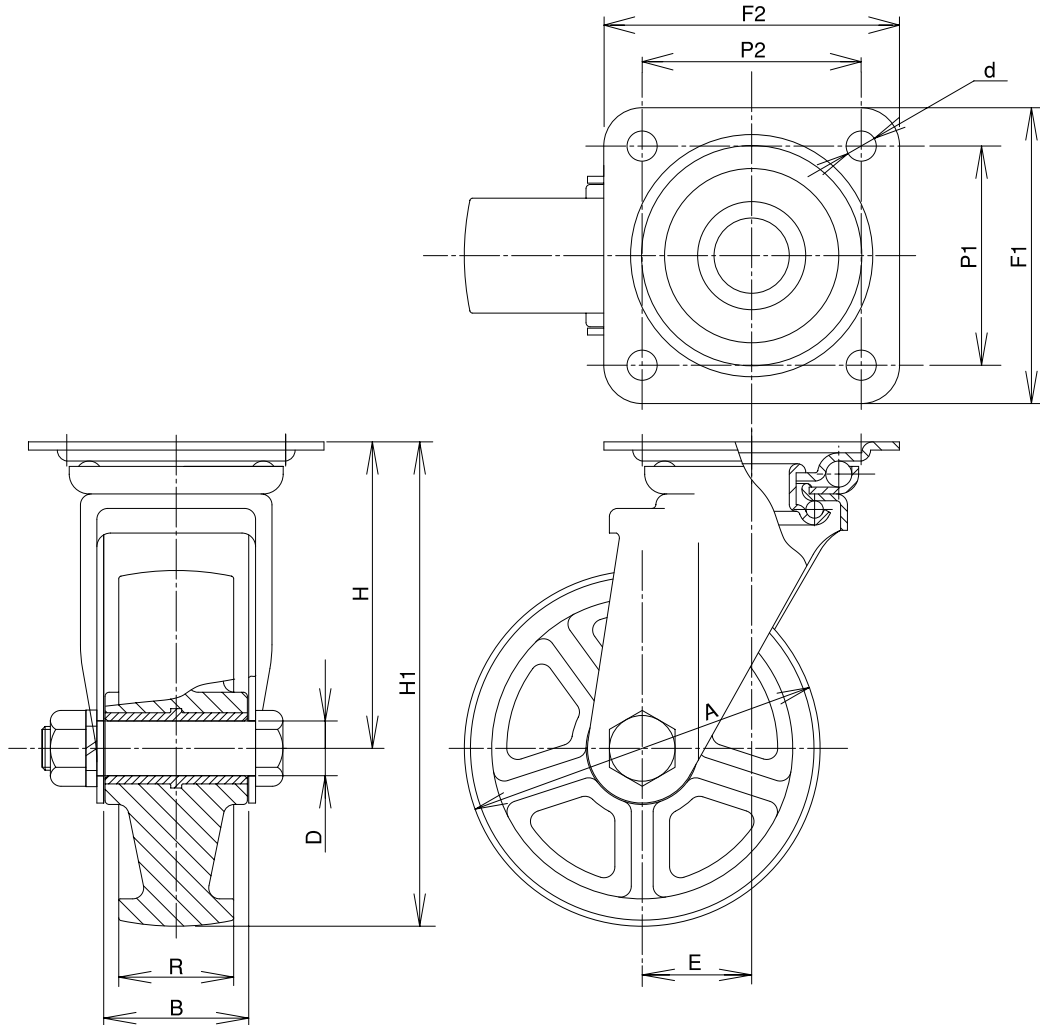

Stainless Steel Caster Series

## 【Bracket Dimensions】

Unit: mm

Size A	Load Capacity		Bracket Height H	Bracket Width B	Weight (g)
	(daN)	(kgf)			
75	150	153.0	63	40	330
100	200	204.0	94	43	710
130	300	306.0	112	53	1,080
150	350	357.0	123	56	1,470
200	500	510.0	150	56	2,170

\* The shaft set is included in the bracket.

## Notice

The materials of JA Type bracket are all stainless steel, but the following wheels are not stainless steel. In addition, stainless steel bearings cannot be set.

Please be careful when selecting a caster.

Steel Rim • Rubber Wheel (S, SR, SH, CR Type)

Steel Rim • Urethane Wheel (SUI, SUIE Type)